



# Interlace, Groundwork Ceiling Clouds

Premier Collection

Interlace Ceiling Clouds is a suspended, acoustic installation featuring refined, entwined patterns designed to complement open interiors, provide architectural depth, and functional benefits. Groundwork is an understated, uniform design that provides aesthetic versatility for a wide range of environments. It is engineered for enhanced sound absorption, making it an ideal solution for improving acoustics and ambiance across any space.

## Specifications

<b>Surface</b>	Ceiling
<b>Material</b>	FilaSorb™ polyester felt
<b>Weight</b>	0.49 lb./ft <sup>2</sup> (±10%)
<b>Standard Sizes</b>	Heights: 6" up to 12" H (2" increments) Widths: 48, 60, 72, 96, 108" W Lengths: 48, 60, 72, 96, 108" L

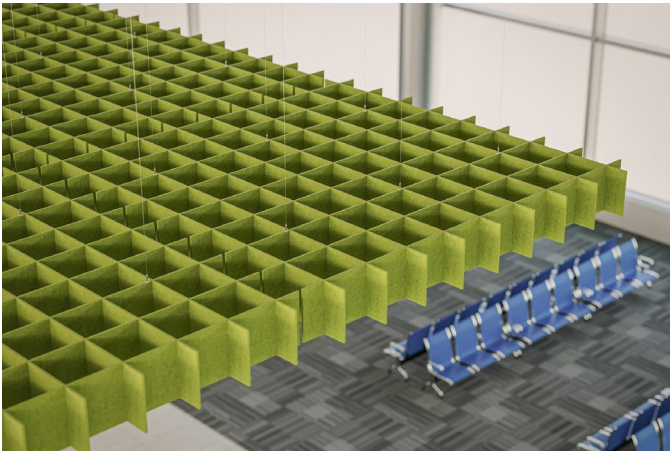

Interlace, Groundwork Ceiling Clouds in Wasabi

## Technical

<b>NRC Rating</b>	0.85, 200mm air gap* 0.80, 400mm air gap*
<b>Fire Test</b>	ASTM E84, Class A CAN/ULC-S102 Flame spread index: 15 Smoke developed index: 200
<b>Water Sorption</b>	ASTM C1104-2019 (A Modified) Water sorbed by weight: 0.20% (based on a 12mm thick panel)
<b>Colorfastness</b>	ISO 105-B02, 6-7

\* Test results available upon request.

## Details

<b>Lead Time</b>	3 – 6 weeks
<b>Origin</b>	Manufactured and assembled in the US
<b>Warranty</b>	Product: 20 years* Colorfastness: 20 years*

\* Conditions apply

## Environmental

<b>Recycled Content</b>	Minimum 60%
<b>Energy</b>	Generated using 40% solar energy
<b>Indoor Air Quality</b>	VOC less than/equal to 0.5mg/m3
<b>Recyclable</b>	100%*
<b>Certifications</b>	Declare Certification - LBC Red List Free (third-party verified) SCS Global Indoor Advantage Gold

\* PET is recyclable through participating partners.



# Colorways

## PREMIER

							
White WH12	Almond AL55	Celery CE65	Sencha SE58	Metal ME03	Flamingo FL61	Quartz QU67	Turmeric TU60
							
Platinum PL04	Pearl PE21	Pistachio PI25	Thistle TH28	Stonewash ST72	Amethyst AM69	Valentine VA70	Wheat WH68
							
Grey GR02	Ivory IV11	Eucalyptus EU71	Peacock PE20	Periwinkle PE23	Lilac LI13	Peach PE19	Popcorn PO26
							
Slate SL27	Milkyway MI74	Wasabi WA29	Sea Salt SE57	Marine MA15	Berry BE06	Peppercorn PE22	Carrot CA08
							
Charcoal CH01	Umber UM54	Oregano OR18	Azure AZ05	Granite GR62	Iris IR10	Shiraz SH63	Currant CU59
							
Piano Black PI24	Walnut WA56	Kale KA12	Denim DE09	Midnight MI16	Flint FL64		

Order samples at [acoufelt.com/colorways](https://acoufelt.com/colorways)



For questions or additional product information,  
visit [acoufelt.com](https://acoufelt.com) or call 800.966.8557.

© 2025 Acoufelt. All rights reserved.

Interlace, Groundwork Ceiling Clouds 06/2025

3

# Sizes

**Standard Sizes**      Heights: 6" up to 12" H (2" increments)  
                                 Widths: 48, 60, 72, 96, 108" W  
                                 Lengths: 48, 60, 72, 96, 108" L

---

## Perspective

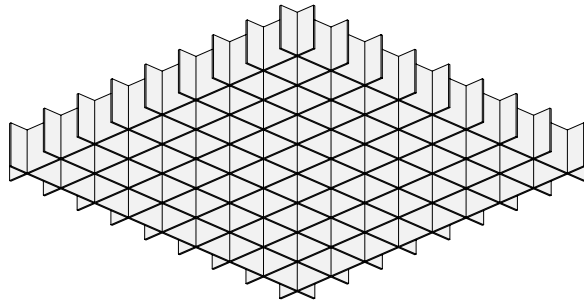

## Plan

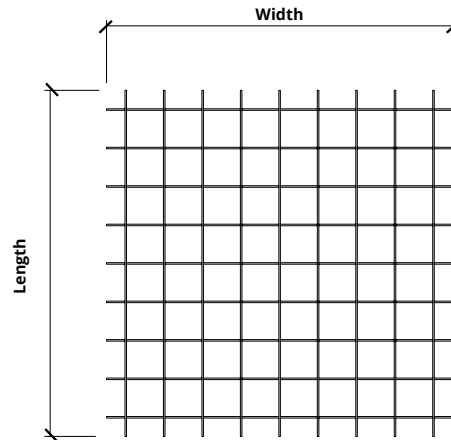

## Elevations

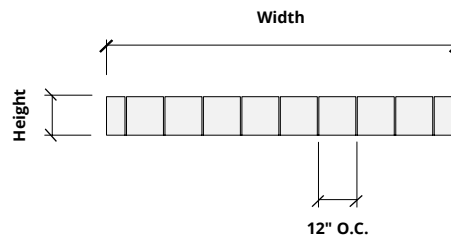
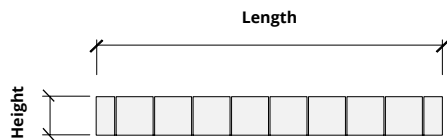

# Mounting Methods

## Cable to deck

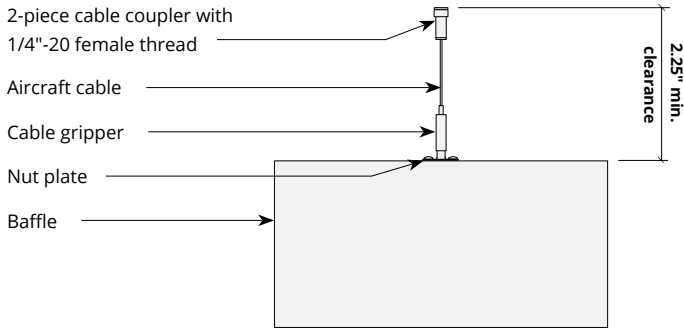

Hardware Kits:  
 HK1006 - 48" Cable  
 HK1010 - 120" Cable

## Cable to T-grid

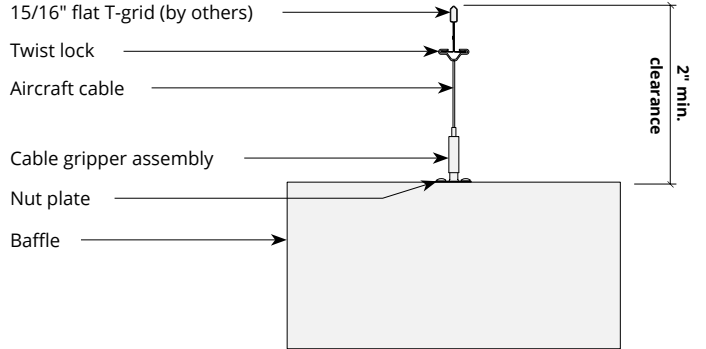

Hardware Kits:  
 HK1008 - 48" Cable  
 HK1012 - 120" Cable

## Cable to strut channel

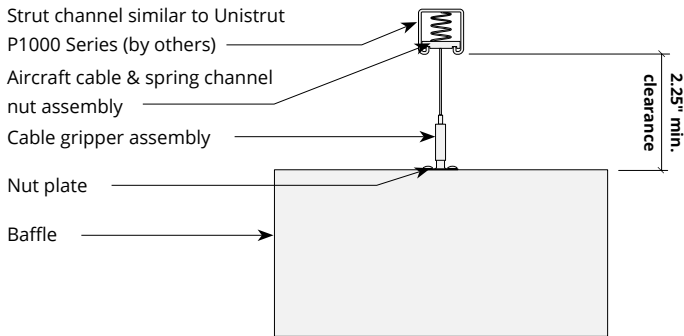

Hardware Kits:  
 HK1009 - 48" Cable  
 HK1013 - 120" Cable

## Swivel cable to deck

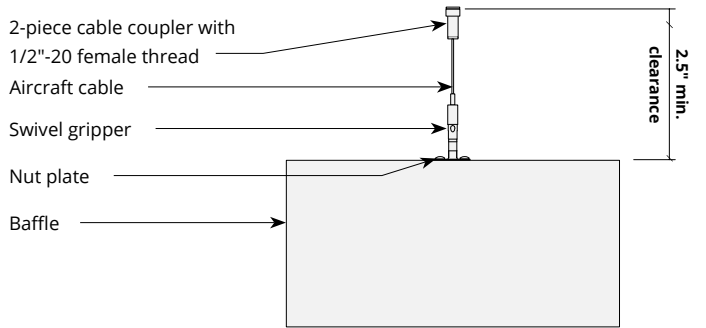

Hardware Kits:  
 HK1007 - 48" Cable  
 HK1011 - 120" Cable



# Acoustic Performance

<b>Test Method</b>	ISO 11654-2002
<b>Install Method</b>	E200, E400
<b>Rating Method</b>	ASTM C423-09a
<b>Test Results</b>	NRC 0.85, 200mm air gap SAA 0.86, 200mm air gap NRC 0.80, 400mm air gap SAA 0.83, 400mm air gap

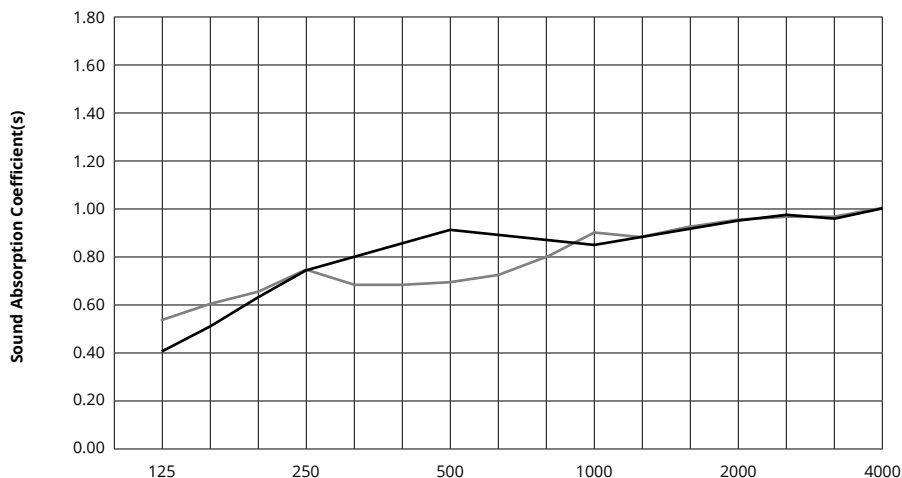

	Frequency f (Hz)	125	250	500	1000	2000	4000	NRC
	12mm, 200mm air gap	0.40	0.75	0.90	0.85	0.95	1.00	0.85
	12mm, 400mm air gap	0.55	0.75	0.70	0.90	0.95	1.00	0.80

## What is a Noise Reduction Coefficient (NRC)?

You'll find the NRC rating in the specifications of all of our products. This acronym stands for Noise Reduction Coefficient, and is expressed as a single number, a rating that describes the degree to which acoustic products can absorb sound.

You can use NRC values to understand the overall performance of our acoustic wall and ceiling products. The higher the NRC, the better the product is at soaking up the sound.

*Performance Indices: Noise Reduction Coefficient (NRC) results represent the absorption coefficients measured at the one-third octave bands at 125, 250, 500, 1000, 2000, and 4000 Hz rounded to the nearest 0.05. Acoustic testing has been performed according to the methods mentioned above. Customization of installation of the product could alter the results. Sound Absorption Average (SAA) indicates the absorption coefficient average for the 12 one-third octave bands ranging between 200 and 2500 Hz.*