



## Truss LED Ceiling Baffles

WoodGrain Collection

Popular Truss ceiling baffles with integrated LED lighting produce a lean, aerodynamic look. Diffused LED lighting channels embedded in sound absorbing baffles reduce noise while efficiently illuminating the space. Acoufelt's advanced manufacturing technology gives you the latitude to specify a standard lighting option or embed your own lighting components.

## Specifications

<b>Surface</b>	Ceiling
<b>Material</b>	FilaSorb™ polyester felt
<b>Thickness</b>	1/2", 12mm (±10%)
<b>Weight</b>	0.49 lb./ft <sup>2</sup> (±10%)
<b>Standard Sizes</b>	Height: 3" up to 20" H (1" increments) Depth: 3" up to 12" D (1" increments) Length: 12" up to 108" L (6" increments), 110" L <i>See page 4 for more details. Custom sizes available</i>

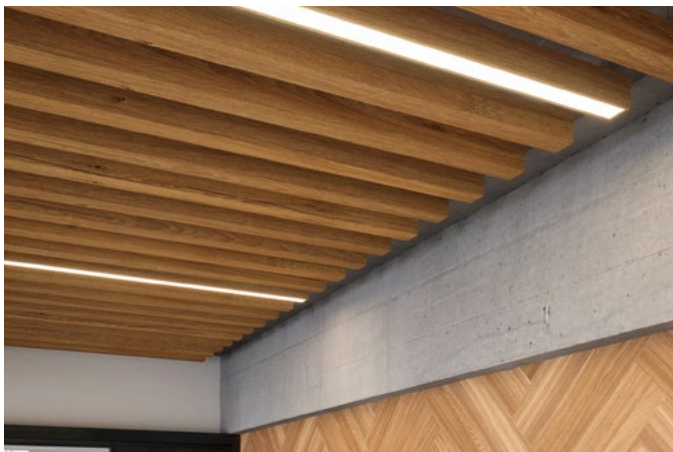

Truss LED Ceiling Baffle in Log Cabin

## Technical

<b>NRC Rating</b>	1.65
<b>Fire Test</b>	ASTM E84, Class A Flame spread index: 15 Smoke developed index: 200
<b>Water Sorption</b>	ASTM C1104-2019 (A Modified) Water sorbed by weight: 0.20% (based on a 12mm thick panel)
<b>Colorfastness</b>	ISO 105-B02, 6-7

## Details

<b>Lead Time</b>	3 – 6 weeks
<b>Origin</b>	Manufactured and assembled in the US
<b>Warranty</b>	Product: 20 years* Colorfastness: 20 years*

\* Conditions apply

## Environmental

<b>Recycled Content</b>	Minimum 60%
<b>Energy</b>	Generated using 40% solar energy
<b>Indoor Air Quality</b>	VOC less than/equal to 0.5mg/m3
<b>Recyclable</b>	100%*
<b>Certifications</b>	Environmental Product Declaration Declare Certification - LBC Red List Free (third-party verified) SCS Global Indoor Advantage Gold

\* PET is recyclable through participating partners.



Call **800.966.8557** with questions or visit **acoufelt.com** for more product information, downloads, and colorways.

# Colorways

## WOODGRAIN



Boat Shed  
WQ02



Picket Fence  
WQ01



Loft  
WQ06

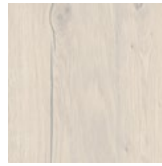

Nordic Plank  
WQ15



White Oak  
WQ13



Baltic Birch  
WQ12



White Elm  
WQ07



Lyed Larch  
WQ30



Woodland Fog  
WQ22



Weathered Slate  
WQ14

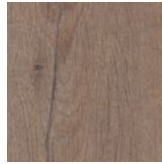

French Bobbin  
WQ08

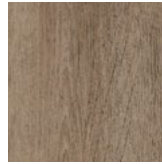

Boardwalk  
WQ10

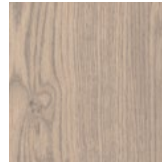

Mountain Lodge  
WQ24

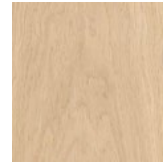

Wine Barrel  
WQ03



Natural Oak  
WQ16



Knotty Spruce  
WQ29



Shadow Oak  
WQ28



Driftwood  
WQ21

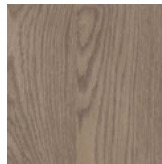

Mocha Legno  
WQ25

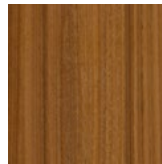

Teak  
WQ18



Fumed Oak  
WQ19

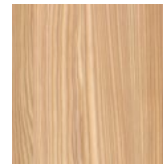

European Larch  
WQ17



Petrified Ash  
WQ23

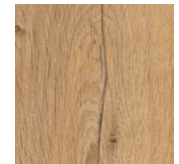

Log Cabin  
WQ04

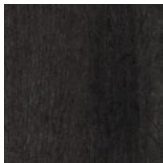

Charred Larch  
WQ09

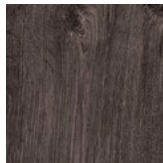

Barn Door  
WQ05

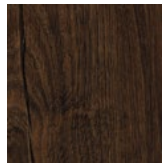

Antique Chest  
WQ11

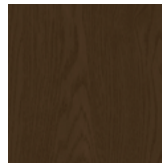

Scorched Timber  
WQ26

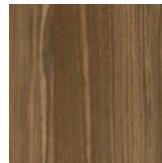

Espresso Oak  
WQ27

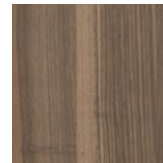

Black Walnut  
WQ20

Order samples at [acoufelt.com/colorways](https://acoufelt.com/colorways)

# Sizes

**Standard Sizes**      Height: 3" up to 20" H (1" increments)  
 Depth: 3" up to 12" D (1" increments)  
 Length: 12" up to 108" L (6" increments), 110" L  
*Custom sizes available*

**Thickness**            1/2", 12mm (±10%)

	3"H	4"H	5"H	6"H	7"H	8"H	9"H	10"H	11"H	12"H	13"H	14"H	15"H	16"H	17"H	18"H	19"H	20"H
3"D	■	■	■	■	■	■	■	■	■	■	■	■	■	■	■	■	■	■
4"D	■	■	■	■	■	■	■	■	■	■	■	■	■	■	■	■	■	■
5"D	■	■	■	■	■	■	■	■	■	■	■	■	■	■	■	■	■	■
6"D	■	■	■	■	■	■	■	■	■	■	■	■	■	■	■	■	■	■
7"D	■	■	■	■	■	■	■	■	■	■	■	■	■	■	■	■	■	■
8"D	■	■	■	■	■	■	■	■	■	■	■	■	■	■	■	■	■	■
9"D	■	■	■	■	■	■	■	■	■	■	■	■	■	■	■	■	■	■
10"D	■	■	■	■	■	■	■	■	■	■	■	■	■	■	■	■	■	■
11"D	■	■	■	■	■	■	■	■	■	■	■	■	■	■	■	■	■	■
12"D	■	■	■	■	■	■	■	■	■	■	■	■	■	■	■	■	■	■

■ Standard sizes

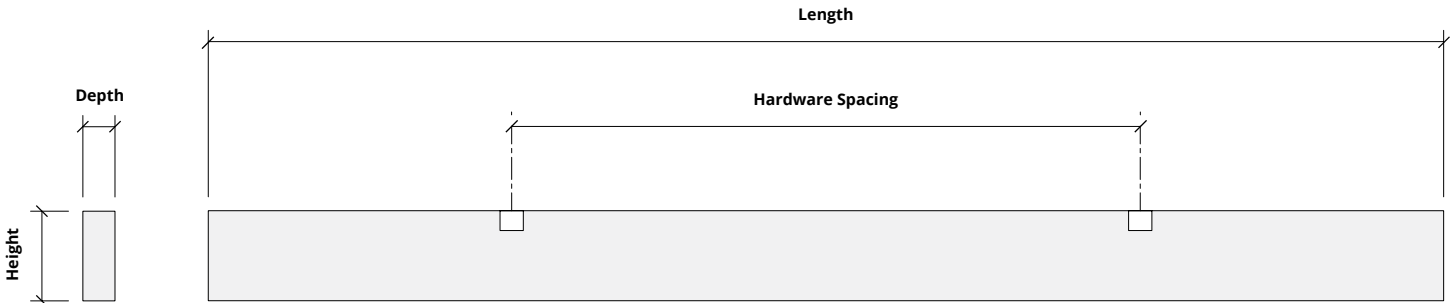

# Hardware Spacing

<b>12, 18" L</b>	6" on center spacing
<b>24, 30" L</b>	12" on center spacing
<b>36, 42, 48, 54" L</b>	24" on center spacing
<b>60, 66, 72, 78, 84, 90" L</b>	48" on center spacing
<b>96, 102, 108, 110" L</b>	60" on center spacing

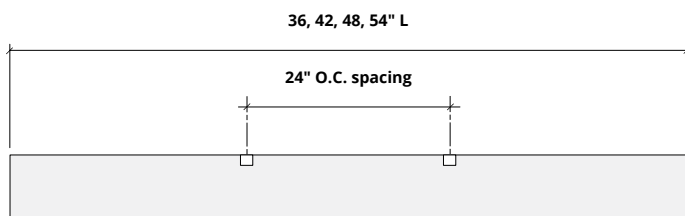
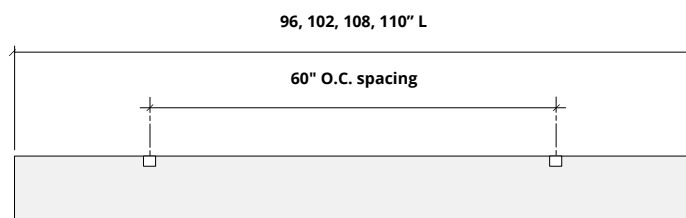
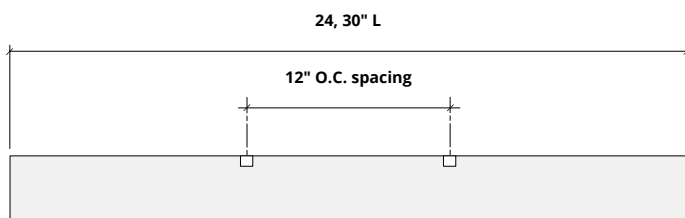
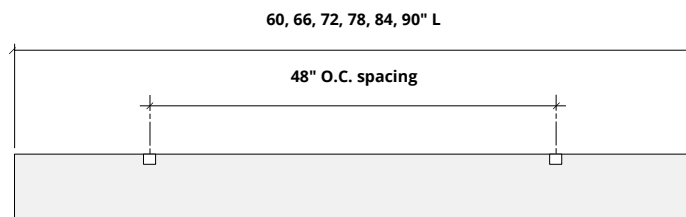
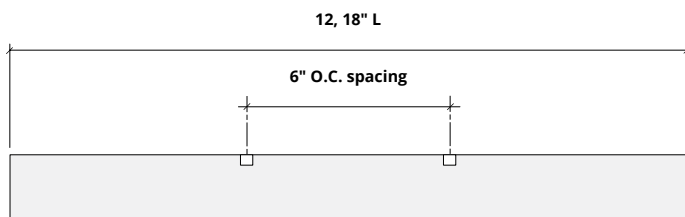

# Mounting Methods

## Cable

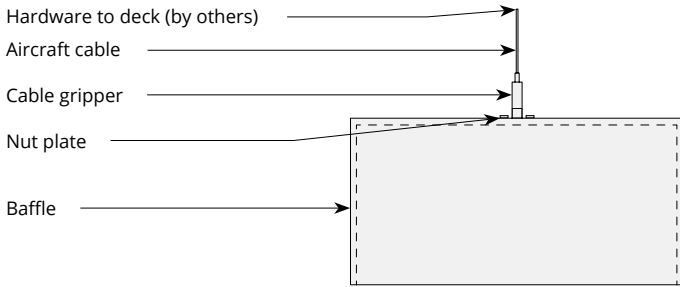

## Cable to deck

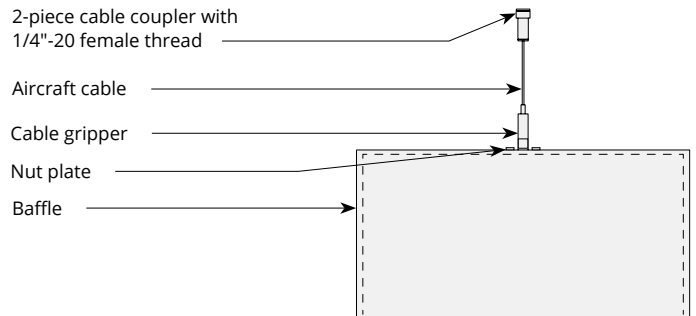

## Cable to T-grid

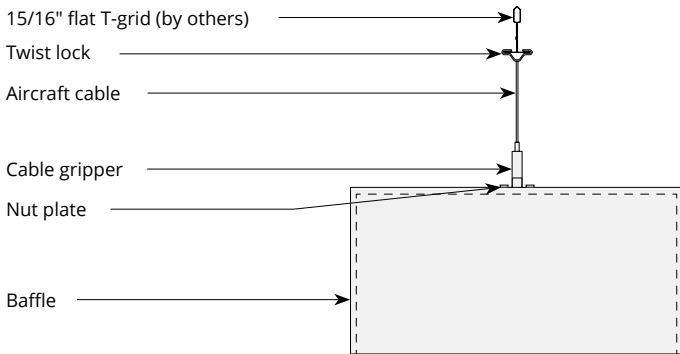

## Cable to Unistrut

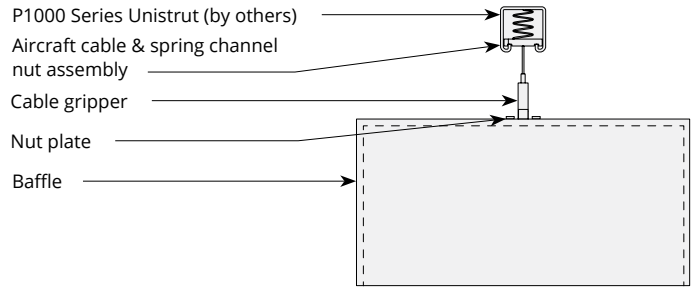

## Swivel cable to deck

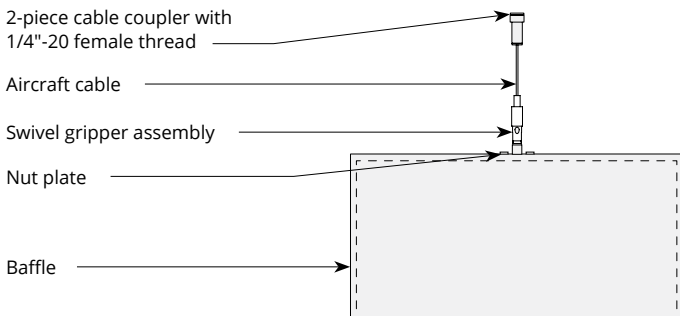

## Threaded rod

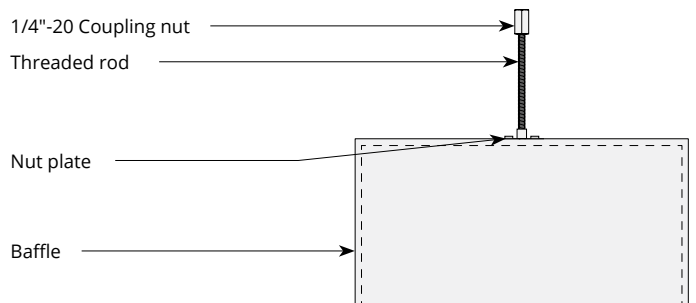

# Mounting Methods cont'd.

## Threaded rod to Unistrut

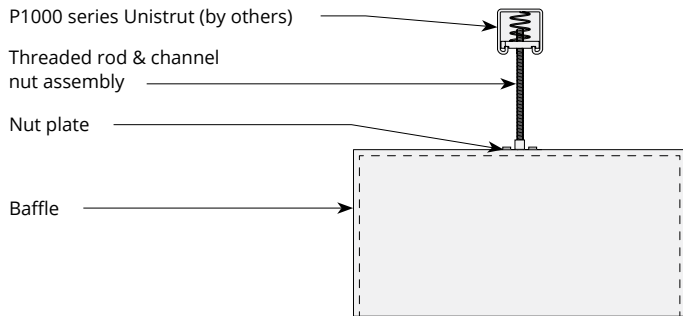

## Direct to Unistrut

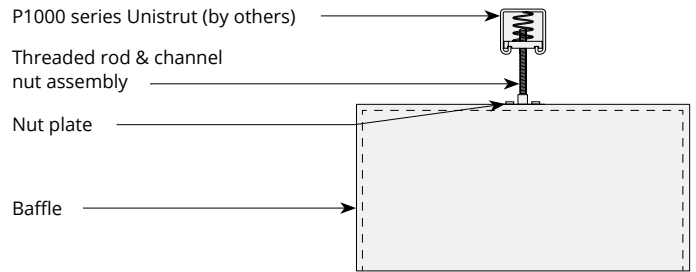

## Twist lock to T-grid

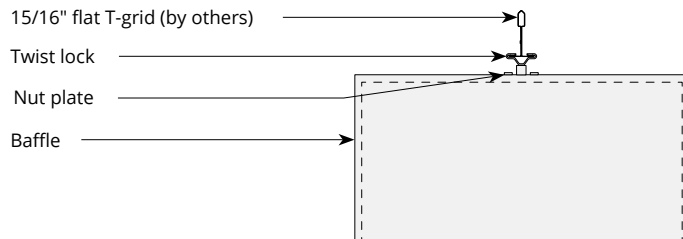



# Acoustic Performance

<b>Test Method</b>	ASTM E795-16
<b>Install Method</b>	J-600
<b>Rating Method</b>	ASTM C423-17
<b>Mounting Method</b>	Sample tested 5 baffles 110" L x 12" D x 3" thickness, hanging 600mm from floor and 152mm from each other
<b>Test Results</b>	NRC 1.65 SAA 1.68



Frequency f (Hz)	125	250	500	1000	2000	4000	NRC
3" Truss Baffle	0.26	0.86	1.25	2.02	2.49	2.49	1.65

## What is a Noise Reduction Coefficient (NRC)?

You'll find the NRC rating in the specifications of all of our products. This acronym stands for Noise Reduction Coefficient, and is expressed as a single number, a rating that describes the degree to which acoustic products can absorb sound.

You can use NRC values to understand the overall performance of our acoustic wall and ceiling products. The higher the NRC, the better the product is at soaking up the sound.

*Performance Indices: Noise Reduction Coefficient (NRC) results represent the absorption coefficients measured at the one third octave bands at 125, 250, 500, 1000, 2000 and 4000 Hz rounded to the nearest 0.05. Acoustic testing has been performed according to the methods mentioned above. Customization of installation of the product could alter the results. Sound Absorption Average (SAA) indicates the absorption coefficient average for the twelve one-third octave bands ranging between 200 and 2500 Hz.*



FIXTURE TYPE \_\_\_\_\_

PROJECT NAME \_\_\_\_\_

LOCATION \_\_\_\_\_



# Uniform Static White (Indoor)

INDOOR WHITE LIGHT TAPE



## I Description

Our Uniform Static White series provides single bin, 3 step color consistency across every single output option and will never create a diode image when paired with any Kelvix channel.

## I Features

- Uses U2835 Diode
- Create a Custom Fixture with Kelvix Channels
- 5-Year Warranty
- UL-Listed
- 3M™ Industrial Adhesive Backing
- For Use with 24V Power Supplies
- Dimmable using Kelvix Power Supplies

## I Series Spec

Series	UNI-WL
Temp/Colors*	1800K–6500K
Input Voltage	24V DC/Constant Voltage
Beam Spread	120°
CRI	Ra 90+, R9 70+
Diode	2835
Diode Pitch	240 LED/m
Binning Tolerance*	ANSI 3Step
Cut Intervals	1.31" (33.3mm)
Dimensions	0.47" (12.0mm) × 0.07" (1.8mm)
Operating Temp.	-4°F (-20°C) to 140°F (60°C)
Storage Temp.	-4°F (-20°C) to 158°F (70°C)

## I Product Code Builder

Series	Location	Output*	Temp/Color*	Voltage	Modification
<b>UNI-WL</b>	<b>I</b>			<b>24V</b>	<b>NA</b>
<b>UNI-WL</b> – Uniform Static White	<b>I</b> – Indoor	<b>100</b> – 100 lm/ft <b>200</b> – 200 lm/ft <b>300</b> – 300 lm/ft <b>400</b> – 400 lm/ft <b>500</b> – 500 lm/ft <b>750</b> – 750 lm/ft <b>1000</b> – 1000 lm/ft <b>1250</b> – 1250 lm/ft <b>1500</b> – 1500 lm/ft	<b>18K</b> – 1800K <b>22K</b> – 2200K <b>24K</b> – 2400K <b>27K</b> – 2700K <b>30K</b> – 3000K <b>35K</b> – 3500K <b>40K</b> – 4000K <b>50K</b> – 5000K <b>65K</b> – 6500K	<b>24V</b> – 24V DC	<b>NA</b> – None
Example: UNI-WL-I-100-18K-24V-NA					

\* Customizable—Consult Factory

Conforms to ANSI/UL Standard 2108  
Certified to CAN/CSA Standard C22.2 NO. 250.0



## I Series Data

Output (lm/ft)	UNI-WL 100	UNI-WL 200	UNI-WL 300	UNI-WL 400	UNI-WL 500	UNI-WL 750	UNI-WL 1000	UNI-WL 1250	UNI-WL 1500	
Lumens (per ft)	1800K	83	162	245	324	391	635	846	1040	1261
	2200K	91	177	267	353	425	670	894	1098	1331
	2400K	93	182	276	365	439	685	914	1123	1361
	2700K	97	189	287	379	457	704	939	1154	1399
	3000K	100	195	295	390	470	720	960	1180	1430
	3500K	103	201	304	402	485	739	986	1211	1468
	4000K	105	205	309	409	493	751	1001	1231	1492
	5000K	106	207	313	414	499	760	1013	1245	1509
	6500K	110	215	325	430	519	758	1011	1243	1506
Wattage <sup>1</sup> (per ft)	0.7	1.3	2.0	2.6	3.4	4.4	5.6	7.2	8.6	
Efficiency (lm/W)	144	147	150	150	140	162	173	164	166	
Max Run Length (ft)	46	30	25	22	19	17	14	11	11	

<sup>1</sup>Power consumption based on average wattage per foot. Refer to Power Chart on page 4 for details.

## I Dimensions

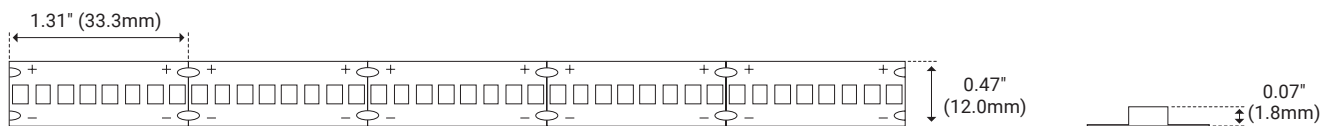



## I Power Feed Accessories\*

### Lead



Unit Number	Length
FML-2C-1	12.00" (305.0mm)
FML-2C-2	24.00" (0.60m)
FML-2C-3	36.00" (0.91m)
FML-2C-6	72.00" (1.82m)
FML-2C-12	144.00" (3.65m)
FML-2C-15	180.00" (4.57m)
FML-2C-20	240.00" (6.09m)

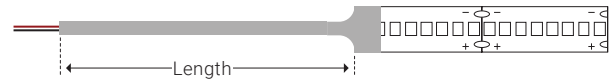

For leads on both input and output, specify 2x FML-xC-xx per run.

### Lead with DC Plug



Unit Number	Length
FML-2C-DC-1-M	12.00" (305.0mm)
FML-2C-DC-1-F	12.00" (305.0mm)
FML-2C-DC-6-M	72.00" (1.82m)
FML-2C-DC-6-F	72.00" (1.82m)
FML-2C-DC-10-M	120.00" (3.04m)
FML-2C-DC-10-F	120.00" (3.04m)

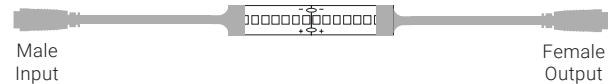

Male Input

Female Output

### Connector



Unit Number	Length
FMC-2C-1.5I	1.50" (38.0mm)
FMC-2C-3I	3.00" (76.0mm)
FMC-2C-6I	6.00" (152.0mm)
FMC-2C-9I	9.00" (228.0mm)
FMC-2C-1	12.00" (305.0mm)
FMC-2C-2	24.00" (0.60m)

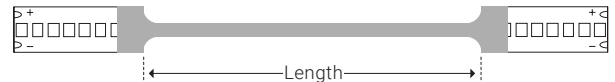

\* Customizable—Consult Factory



## I Power Chart

		UNI-WL-100	UNI-WL-200	UNI-WL-300	UNI-WL-400	UNI-WL-500	UNI-WL-750	UNI-WL-1000	UNI-WL-1250	UNI-WL-1500
Watts	1 ft	0.7	1.5	2.2	3	3.9	5.3	6.7	8.6	10.7
	2 ft	1.5	2.9	4.6	6.1	7.9	10.4	13	16.6	20.5
	3 ft	2.3	4.5	6.7	9	11.7	15.5	19.2	24.1	29.6
	4 ft	3.1	5.9	8.9	11.8	15.4	20.2	25	31.3	38.1
	5 ft	3.8	7.4	11	14.6	18.6	24.6	29.5	37.4	44.8
	6 ft	4.6	8.8	12.9	17.1	21.9	28.5	34.8	43.2	51.6
	7 ft	5.4	10.1	14.9	19.6	24.8	32.6	39.4	48	56.9
	8 ft	6	11.5	16.8	22.1	28	36.2	43.4	52.8	61.5
	9 ft	6.9	12.7	18.7	24.5	31.1	39.7	47.3	57.4	66.3
	10 ft	7.6	14	20.5	26.7	33.8	43.6	51.3	61.1	70.3
	11 ft	8.3	15.2	22.3	29	36.2	46.5	54.5	65.9	74.4
	12 ft	9	16.4	24.1	31.1	38.5	49.3	57.8	-	-
	13 ft	9.7	17.8	25.8	33	40.7	51.4	60.5	-	-
	14 ft	10.3	18.9	27.4	33.4	42.7	53.8	62.9	-	-
	15 ft	11	19.9	28.7	36.8	44.7	56.9	-	-	-
	16 ft	11.8	21.1	30.4	38.7	46.8	59.3	-	-	-
	17 ft	12.4	22.3	31.8	40.2	48.9	61.7	-	-	-
	18 ft	13	23.3	33.4	41.9	50.3	-	-	-	-
	19 ft	13.7	24.3	34.7	43.5	52.1	-	-	-	-
	20 ft	14.2	25.5	35.8	45	-	-	-	-	-
	21 ft	14.9	26.4	36.9	46	-	-	-	-	-
	22 ft	15.4	27.5	37.3	47.6	-	-	-	-	-
	23 ft	16.1	28.3	38	-	-	-	-	-	-
	24 ft	16.6	29.3	39	-	-	-	-	-	-
	25 ft	17.2	30.1	40.3	-	-	-	-	-	-
	26 ft	17.8	30.8	-	-	-	-	-	-	-
	27 ft	18.4	31.6	-	-	-	-	-	-	-
	28 ft	19	32.4	-	-	-	-	-	-	-
	29 ft	19.5	33.4	-	-	-	-	-	-	-
	30 ft	20.1	34.2	-	-	-	-	-	-	-
	31 ft	20.7	-	-	-	-	-	-	-	-
	32 ft	21.1	-	-	-	-	-	-	-	-
	33 ft	21.7	-	-	-	-	-	-	-	-
	34 ft	22.2	-	-	-	-	-	-	-	-
	35 ft	22.7	-	-	-	-	-	-	-	-
	36 ft	23.2	-	-	-	-	-	-	-	-
	37 ft	23.7	-	-	-	-	-	-	-	-
	38 ft	24.2	-	-	-	-	-	-	-	-
	39 ft	24.6	-	-	-	-	-	-	-	-
	40 ft	25.1	-	-	-	-	-	-	-	-
	41 ft	25.5	-	-	-	-	-	-	-	-
	42 ft	26	-	-	-	-	-	-	-	-
	43 ft	26.3	-	-	-	-	-	-	-	-
	44 ft	26.8	-	-	-	-	-	-	-	-
	45 ft	27.2	-	-	-	-	-	-	-	-
	46 ft	27.4	-	-	-	-	-	-	-	-